

The National Museum of Ras Al Khaimah showcases some of the emirate's most sophisticated and well-curated collections of history, archaeology, and ethnography. Since 19 November 1987, it has been housed in what was once the RAK Fort, a glimpse of the Arabian Gulf's traditional architecture.

SCAN HERE



For Digital Floorplan

## Museum FLOOR PLAN

### Ground Floor



### Ground Floor

- A. Entrance
- B. Majlis
- C. Welcoming Area
- D. Gents Washroom & Prayer Room
- E. Madbasa galleries
- F. Julfar galleries
- G. Archaeology galleries
- H. Ladies & Unisex Wheelchair Washrooms
- I. Weaponry Exhibition
- J. Ethnography: Emirati Wedding
- K. Liwan : Youth Corner
- L. Qahwa (Traditional Coffee) area
- M. Garden
- N. Gift Shop

### First Floor

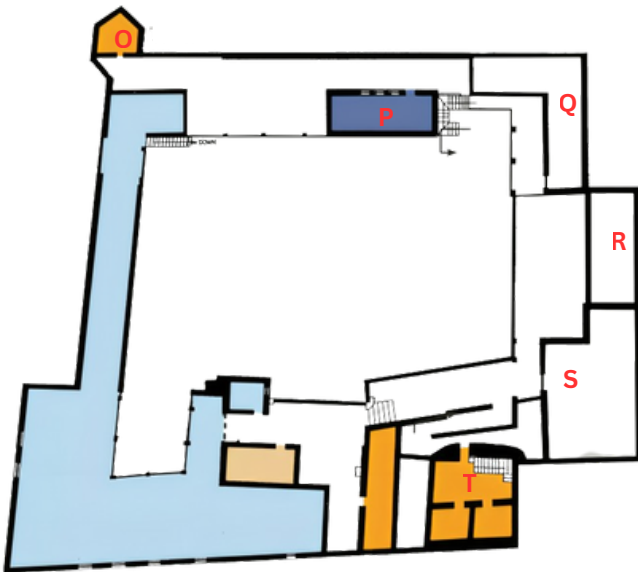

### First Floor

- O. Northwest tower
- P. Wind tower
- Q. Pre Oil Emirati bedroom
- R. Education Classroom
- S. Quwasim Room (by appointment)
- T. Watchtower

### Opening Hours:

Summer time : 9 : 00 - 19 : 00

Winter time : 8 : 00 - 18 : 00

Closed on MONDAYS

Opening hours during Ramadan and Public holidays may vary.

### Ticket :

Tickets can be purchased at the Museum's ticket office.

Adults: AED 5

Children (age 5-13) : AED 2

Children under 5 : Free

POD + 1 care taker : Free

**Car Parking** : Free

**Accessibility** : accessible for wheelchairs and stroller

### For any inquiries

Telephone : + 97172339900

Follow us on @nmrak\_uae